

ORION

Design: R.I.



TAVOLO - DINING TABLE

CARATTERISTICHE TECNICHE:

Struttura:

Legno multistrato di abete impiallacciato in rovere, lucidato e rifinito con tecnica a poro aperto.

Top :

Piano d'appoggio in pelle, disponibile in diverse tipologie e categorie.

Impiallacciatura in pelle di capra disponibile su richiesta.

PRODUCT TECHNICAL SHEET:

Structure:

Multi-ply fir wood veneered in oak wood , polished and finished with open pore technique.

Top :

Table top in leather , available in different types and categories.

Goat skin leather veneer available upon request.

TAVOLO / TABLE

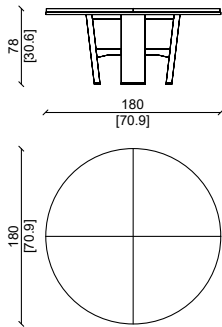

TAVOLO / TABLE

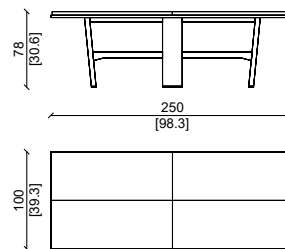

TAVOLO / TABLE

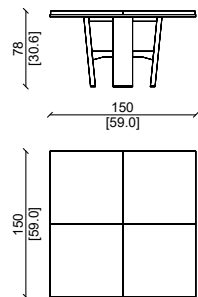

Struttura in rovere , rivestimento in pelle tuscanly perla.
Ash wood structure, tuscanly perla leather.