

BOBBIE

Design: Andrea Pinori - Giorgio Balestri



DIVANO BRACCIOLO TAPPEZZATO
SOFA WITH PADDED ARMREST

CARATTERISTICHE TECNICHE:

Struttura:

Divano realizzato in legno multistrato di abete.

Imbottiture:

Cuscino della seduta :

Realizzato in poliuretano espanso in varie densità e memory foam, il tutto rivestito in piuma d'oca sterilizzata.

Cuscino schienale:

rivestito in piuma d'oca sterilizzata.

Rullo in poliuretano espanso rivestito in falda sintetica.

Rivestimento:

Rivestimento eseguito artigianalmente in varie categorie di pelle e tessuti, cucitura decorativa realizzata con tecnica "pettine".

Base:

Piedini disponibili in noce canaletto .

* Prodotto personalizzabile

PRODUCT TECHNICAL SHEET:

Internal structure:

Fir wood multi-ply.

Cushions padding:

Sitting cushions :

External padding with natural , sterilized goose feathers

Internal center with memory foam and expanded polyurethane with different density.

Back cushions :

Soft padding with natural , sterilized goose feathers , with a core support in expanded polyurethane.

Roll cushion in expanded polyurethane with soft synthetic wrapping

Upholstery :

High quality leathers or fabrics available in different categories

Decorative "comb-style" tailor made stitching.

Base:

Solid wood feet available in walnut "canaletto".

* This item can be customized upon request.





DIVANO 4 POSTI - SOFA 4 SEATER

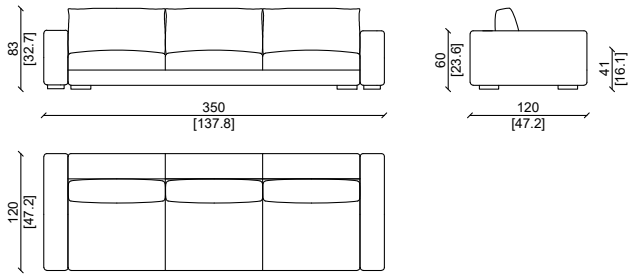

DIVANO 3 POSTI - SOFA 3 SEATER

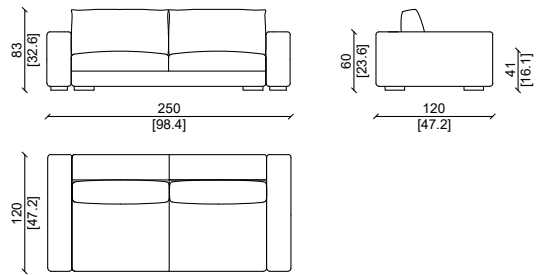

ELEMENTO - ELEMENT 325cm

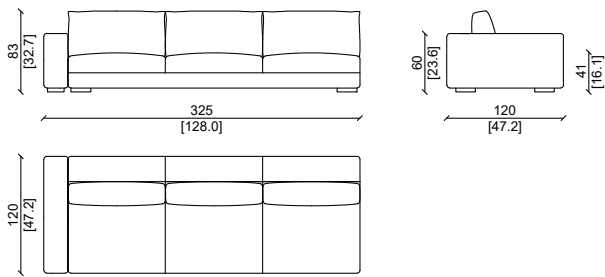

ELEMENTO - ELEMENT 225cm

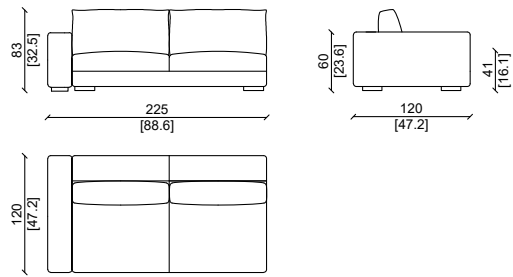

ELEMENTO - ELEMENT 125cm

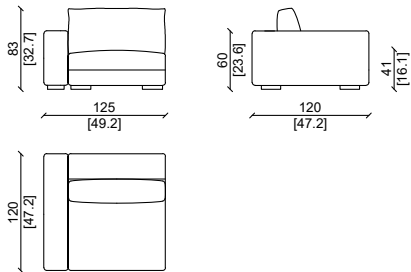

ANGOLO - CORNER

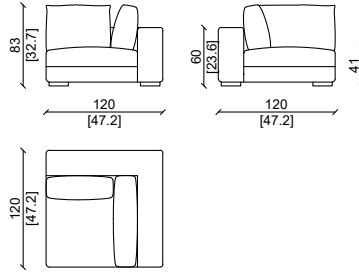

Pelle in river choco.
River choco leather.