

STAR

Design: I.D. Ulivi



TAVOLINI - COFFEE TABLES

CARATTERISTICHE TECNICHE:

Struttura delle gambe: multistrato curvato impiallacciato delle essenze delle categorie di Ulivi Salotti, con terminale realizzato in massello di noce americano.

Piedi: in metallo in finitura nero gofrato oppure delle finiture di Ulivi Salotti.

Piano: disponibile in marmo delle categorie di Ulivi Salotti, oppure impiallacciato. Sottopiano: realizzato in multistrato impiallacciato con cornice di massello di legno.

PRODUCT TECHNICAL SHEET:

Leg structure: curved multilayer wood veneered with species from the Ulivi Salotti categories, featuring end caps in solid american walnut.

Feet: metal feet in textured black or in finishes from the Ulivi Salotti collection.

Top: available in marble from the Ulivi Salotti categories, or veneered wood.

Underside: constructed in veneered multilayer wood with a solid wood frame.

TAVOLINO - COFFEE TABLE D 60

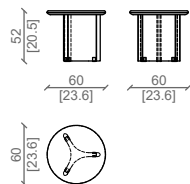

TAVOLINO - COFFEE TABLE D 80

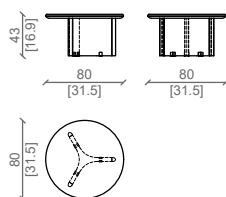

TAVOLINO - COFFEE TABLE D 120

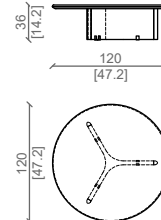

TAVOLINO - COFFEE TABLE 60X120

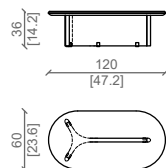

TAVOLINO - COFFEE TABLE 60X140

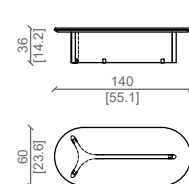

TAVOLINO - COFFEE TABLE 80X120XH43

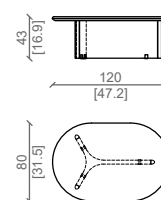

TAVOLINO - COFFEE TABLE 80X120XH36

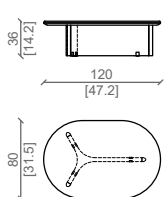

TAVOLINO - COFFEE TABLE 80X140XH43

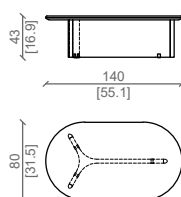

TAVOLINO - COFFEE TABLE 80X140 H36

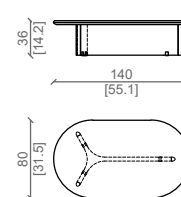

TAVOLINO - COFFEE TABLE 120X180

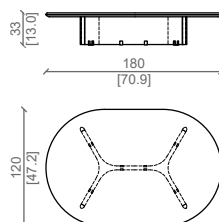

Struttura in noce americano e top intrigo.
American Walnut structure and intrigo marble top.